

# Mountview<sub>RE</sub>

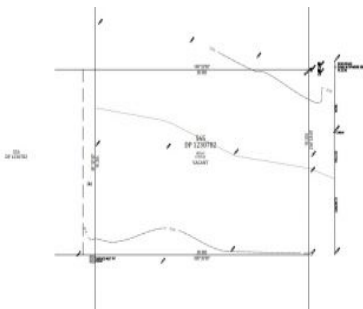

Disclaimer: Dimensions are approximate and are for illustrative purposes only.



## 30 April Cres (Grantham Farm) Riverstone NSW

Mountview Real Estate proudly presents 30 April Crescent, Grantham Farm, to the market.

Perfectly positioned within the elevated and highly sought-after Rosebank Estate, this expansive 487sqm rectangular parcel offers an exceptional opportunity for families, investors, and builders looking to secure prime land in the thriving Grantham Farm precinct.

Registered and ready to build, this premium block provides flexibility and convenience, allowing you to design and construct your dream home with the builder of your choice.

Property Features:

[For full version visit the website](https://www.mountviewre.com.au)

**Type** : Land  
**Price** : \$ 1,000,000  
**Land Size** : 487 sqm  
**View** : <https://www.mountviewre.com.au/sale/nsw/western-sydney/riverstone/residential/land/8626143>



**Inder Nirman**  
02 8883 3592