

Mountview_{RE}



95 Bridge Street Schofields NSW

3 2 4

Located in an ideal location in Schofield, this Northwest facing huge 1227m² Block of land with a large 3-bedroom split level brick veneer home awaits your inspection. This residence showcases a balance of space and open plan living with easy flow of kitchen & dining room and plenty of space for the family with two separate living and family rooms.

Ideal for subdivision, dual occupancy, or further development like medical centre or childcare centre (STCA) with over 20 meter frontage this block of land offers plenty of opportunities.

Further features include:
~ Formal Lounge room at front

[For full version visit the website](https://www.mountviewre.com.au)

Type : House
Price : \$ 1,600,000
View : <https://www.mountviewre.com.au/sale/nsw/western-sydney/schofields/residential/house/8124961>



Malwinder Pandher
02 8883 3592



Ravi Goyal
02 8883 3592

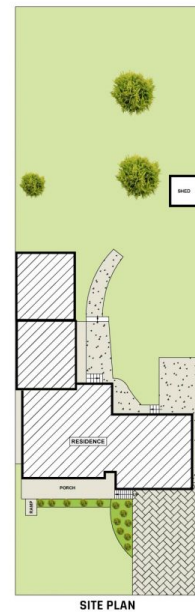
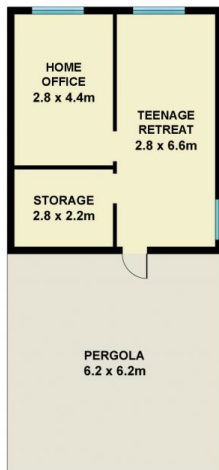

This floorplan including furniture, fixture measurements and dimensions are approximate and for illustrative purposes only. All enquiries must be directed to the agent, vendor or party representing this floor plan

95 BRIDGE STREET SCHOFIELDS

