

9 Dorcas Glade Schofields NSW

4 2 1

Ravi Goyal and Mountview Real Estate is proud to present this exquisite family home to the market for sale. Situated within the premium Riverbank Public and Ponds High School catchment, this near-new home complete with custom finishes and upgrades, has a location that is second to none, within walking distance to Beacon Park and an abundance of other amenities. Additionally, only a short distance away from Schofields Train Station, Tallawong Metro Station, and Schofields Village, this is a home for the family and is situated in the heart of one of the most family-friendly communities in Sydney.

Property Features Include:

- ? Solar Panels provided
- ? Beautiful kitchen with 40mm stone bench-tops, stainless steel appliances, 900mm gas cooking and dishwasher

Price : \$ 951,500

View : <https://www.mountviewre.com.au/sale/nsw/western-sydney/schofields/residential/townhouse/7896526>



Ravi Goyal
02 8883 3592



Hesh Rasitha
02 8883 3592

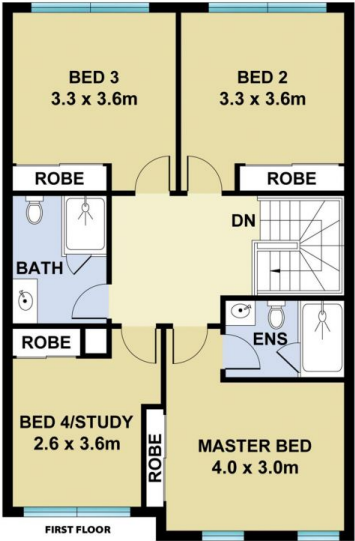
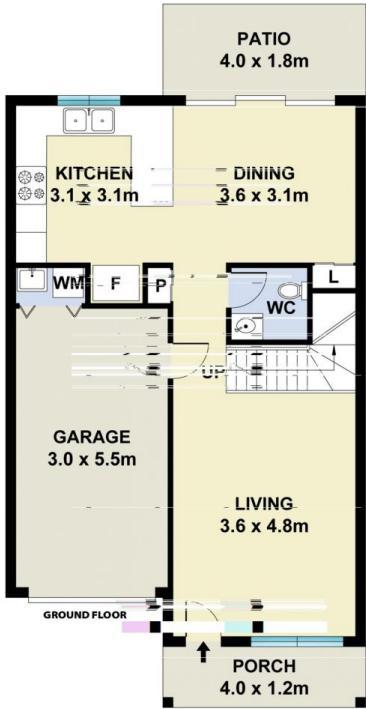

This floorplan including furniture, fixture measurements and dimensions are approximate and for illustrative purposes only. All enquiries must be directed to the agent, vendor or party representing this floor plan

9 DORCAS GLADE SCHOFIELDS

