

Mountview_{RE}



24 Georgina Crescent Marsden Park NSW

5 3 2

Inder Nirman & Mountview RE proudly presents this East-Facing Brand-New, Architecturally Designed, Custome-built Modern Luxury Home.

This is your opportunity to own a home that stands out from the rest. Make a statement with your address and live in the future today. Don't miss out on this extraordinary opportunity. Contact us for a private viewing and take the first step towards an ultra-modern lifestyle!

Key Features to Highlight:

- ~ Impressive Modern Facade with Alukabond Finish
- ~ Acrylic Textured Rendered on all Sides
- ~ Master bedroom with stylish ensuite and a walk-in-robos
- ~ 800*1600 tiles at the ground floor & timber flooring upstairs throughout
- ~ Expansive Open-Concept living area with 4.5M high

Price : \$ 1,780,000
Land Size : 436 sqm
View : <https://www.mountviewre.com.au/sale/nsw/western-sydney/marsden-park/residential/house/7800296>



Inder Nirman
02 8883 3592



Raman Brar
02 8883 3592

<https://www.mountviewre.com.au>

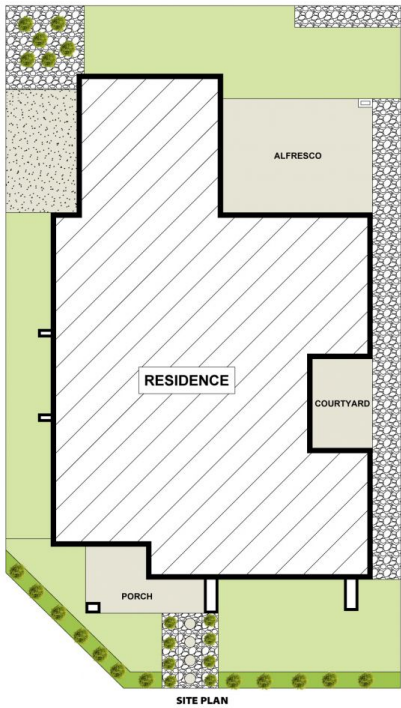

This floorplan including furniture, fixture measurements and dimensions are approximate and for illustrative purposes only. All enquiries must be directed to the agent, vendor or party representing this floor plan

24 GEORGINA CRESCENT MELONBA

