

Mountview^{RE}

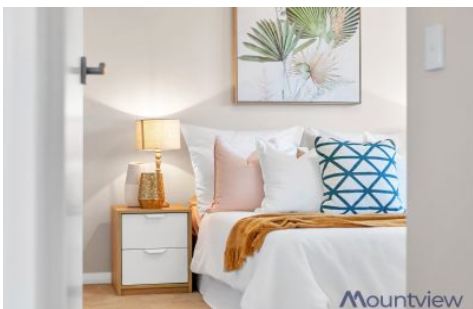

21 Angove Street Rouse Hill NSW

4 3 2

Mountview RE Proudly presents this beautiful home, offering convenience and accessibility right in the heart of Rouse Hill.

Features:

- *Four spacious bedrooms containing built-in wardrobes. The main bedroom features a large walk-in wardrobe, ensuite bathroom and its own personal terrace.
- *Open plan living and dining areas, perfect for entertaining guests.
- *Beautifully designed kitchen, containing premium materials and modern appliances from Westinghouse.
- *Functional features including ducted air conditioning, intercom system and alarm system.

Situated only 2 kilometers from Tallawong Metro Station, and within easy reach of quality school's, family parks,

Building Size : 240 sqm
Land Size : 351 sqm
View : <https://www.mountviewre.com.au/lease/nsw/hills/rouse-hill/residential/house/6705519>



Georgette Siew
02 8883 3592



Mvre Rentals
02 8883 3592

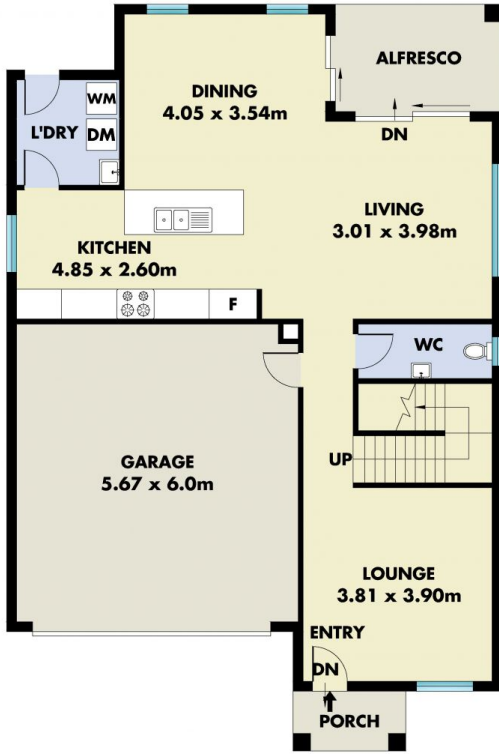

GROUND FLOOR

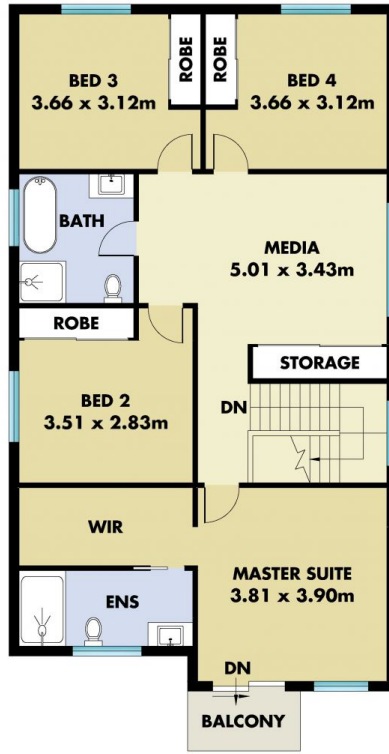

FIRST FLOOR

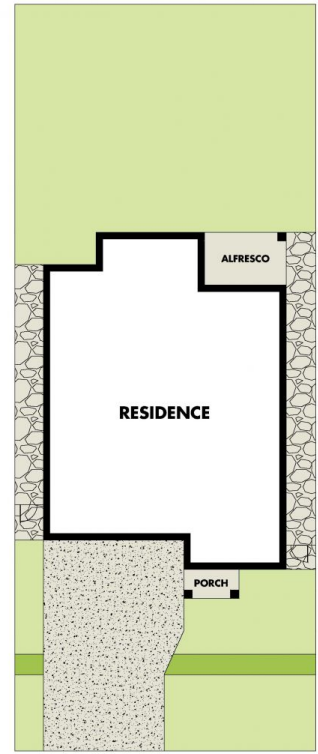

SITE PLAN (NOT TO SCALE)

This floor including furniture, fixture measurements and dimensions are approximate and for illustrative purposes only. All enquiries must be directed to the agent, vendor or party representing this floor plan.

21 Angove Street, Rouse Hill

